



Towel Folder and Stacker

SPECIFICATION

Standard Features :

- The first and second length fold of the IMAGE STF are executed by belt reverse fold after the two lengthfold, one crossfold made combined with stacking.
- With the above combination we can make one or two length folds with one crossfold and stacking.
One, two or three stacks are available in the IMAGE STF
- The different towels can be sorted automatically to two or three different stackers. The standard IMAGE STF has a return to operate conveyor.
- PLC-system and control panel display are self programmable to set for each towel the correct programmed.

Optional :

- Stop conveyor before crossfolding.
- Towel length up to 2,400 mm.
- IMAGE STF selective 2 with two stackers.
- IMAGE STF selective 3 with three stackers.
- Collecting and discharge conveyor.
- Roll-off conveyor for automatic strapping.
- Corners inside or outside.

Technical Information :

- Electrical
 - Voltage : 3x400V+N+PE / 50 Hz
 - Power : 2.5 kW, Fuses 10 A
- Pneumatic
 - Pressure : 6-10 Bar
 - Consumption : 5000NL/1000 towels
 - Connection : 3/8" (1/2" tube)
- Miscellaneous
 - Noise level : 75 dBA
 - Speed : 35 m/min
- Production Materials Towels
 - Max. size : 1.8 m x 1.0 m
 - Min. size : 0.4 m x 0.4 m

Specification of design is subject to change without notice.
For additional options please consult factory and distributor.

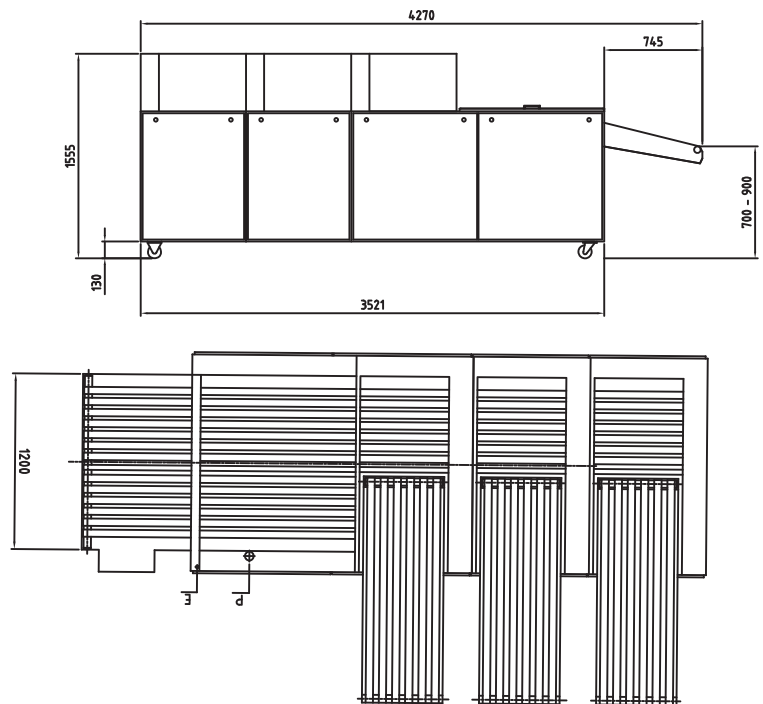
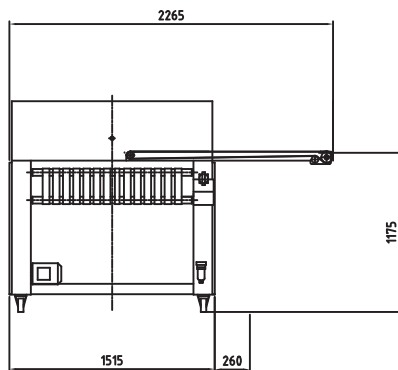

UKAS
MEMBER OF REGISTER OF STANDARDS (HOLDINGS) LTD.
ISO 9001 : 2008



UKAS
MEMBER OF REGISTER OF STANDARDS (HOLDINGS) LTD.
ISO 14001 : 2004

ACCURATE TECHNOLOGIES CO., LTD.

Bangkok, Thailand Phone : +66(0)2740-5511 (Auto) Fax : +66(0)2752-2773

Website : www accuratethai.com Email : sales@ accuratethai.com

Rev. 2015-001